



Falcon-I MODBUS RTU Gateway

PRODUCT OVERVIEW

The Falcon-I modbus gateway allows you to seamlessly interconnect PLC control systems, modbus enabled industrial devices, sensors, or serial devices and their connected devices to the Muraqib platform.

SAFE AND ISOLATED DATA MONITORING

The Falcon-I modbus IIoT gateway's primary function is to safely collect and deliver the data to Muraqib platform using state of the art encryption and fully isolated hardware.

EASY CONFIGURATION – NO PROGRAMMING REQUIRED

The Falcon-I modbus IIoT gateway needs very little configuration to work and it can be done via the Muraqib platform or the mobile app. You just have to connect it with a wifi device and you are good to go.

FEATURES AND BENEFITS

- Supports modbus master, slave, and sniffing modes
- Muraqib cloud platform subscription provided with the devices
- Supports serial baudrate: 300, 600, 1200, 2400, 4800, 9600, 19,200, 38,400, 57,600 and 115,200.
- Supports RS485 and RS232 physical layer
- Modbus master can support upto 100 registers
- Modbus master supports 01H, 02H, 03H, 04H, 05H, 06H, 0FH and 10H function codes
- Modbus slave supports 01H, 02H, 03H, 04H, 05H, 06H, 0FH and 10H function codes
- 3kV Electrical isolation for RS485 and RS232 port

TECHNICAL SPECIFICATIONS

PHYSICAL SPECIFICATION

DIMENSIONS (WXLXH)	25MM X 78MM X 93MM
BODY MATERIAL	PA66
BASE LATCH MATERIAL	STEEL, TIN-PLATED
MOUNTING	DIN-RAIL (EN 50022 STANDARD)
WEIGHT	300 GRAMS
OPERATING TEMPERATURE	-25 TO +65 °C OR -13 TO +149 °F
STORAGE TEMPERATURE	-40 TO +85 °C OR -40 TO +185 °F

ELECTRICAL SPECIFICATION

INPUT VOLTAGE	220 VAC 5%
RS232 VOLTAGE LEVELS	-10V TO 10V
RS485 VOLTAGE LEVELS	5V TO -5V
GALVANIC ISOLATION	YES, ON BOTH THE INTERFACE AND POWER

COMMUNICATION SPECIFICATION

RS485/RS232 SUPPORTED BAUDRATES (BPS)	300,600, 1200, 2400, 4800, 9600, 19,200, 38,400, 57,600 AND 115,200
--	--

MODBUS SPECIFICATION

MODBUS PROTOCOL	MODBUS RTU
MODBUS MODES	MASTER, SLAVE AND SNIFFING
MODBUS SUPPORTED FUNCTION CODES	01H, 02H, 03H, 04H, 05H, 06H, 0FH AND 10H

SERIAL SPECIFICATION

POLL COMMANDS	3 COMMANDS ARE SUPPORTED TO POLL A SLAVE
----------------------	--

WIFI SPECIFICATION

WIFI PROTOCOL	802.11 B/G/N (802.11N UP TO 150 MBPS)
WIFI FREQUENCY RANGE	2.4 GHZ ~ 2.5 GHZ

MODBUS SPECIFICATION

MODBUS PROTOCOL	MODBUS RTU
MODBUS MODES	MASTER, SLAVE AND SNIFFING
MODBUS SUPPORTED FUNCTION CODES	01H, 02H, 03H, 04H, 05H, 06H, 0FH AND 10H



CONNECTION SPECIFICATION/PIN CONFIGURATION

POWER SUPPLY 220VAC

PIN NO	SYMBOL	FUNCTION
1	L ~ 220	220VAC - PHASE
2	NC	NOT CONNECTED
3	N ~ 220	220VAC - NEUTRAL
4	PE	EARTH

MODBUS / RS-485

PIN NO	SYMBOL	FUNCTION
5	GND	GROUND
6	B	RS-485 - DATA - A
7	A	RS-485 - DATA - B

SERIAL COMMUNICATION

PIN NO	SYMBOL	FUNCTION
8	Rx	RS-232 SERIAL DATA (TRANSMIT)
9	Tx	RS-232 SERIAL DATA (RECEIVE)

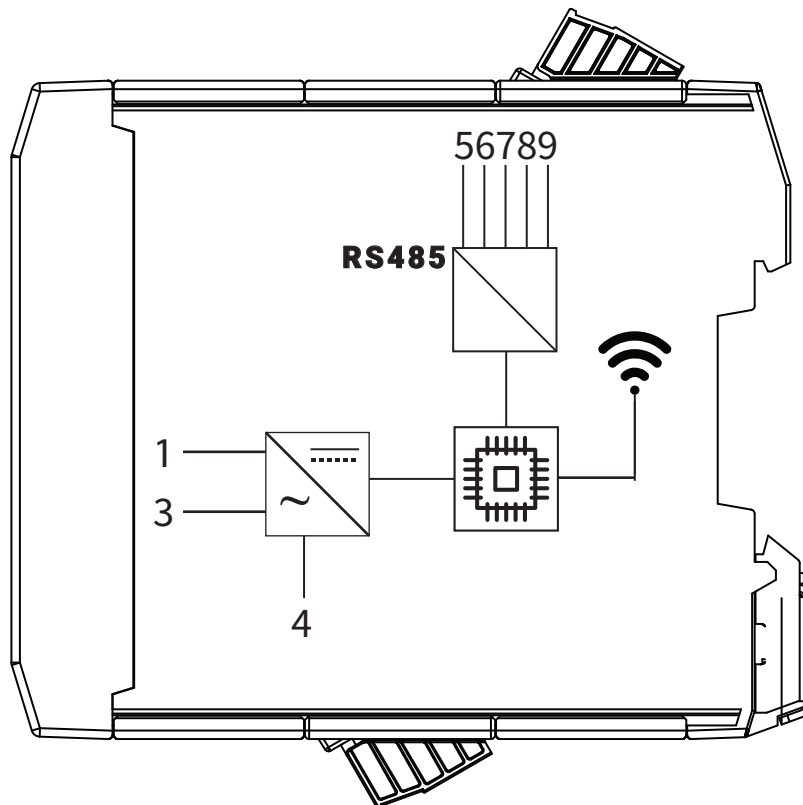

PHYSICAL DIMENSIONS

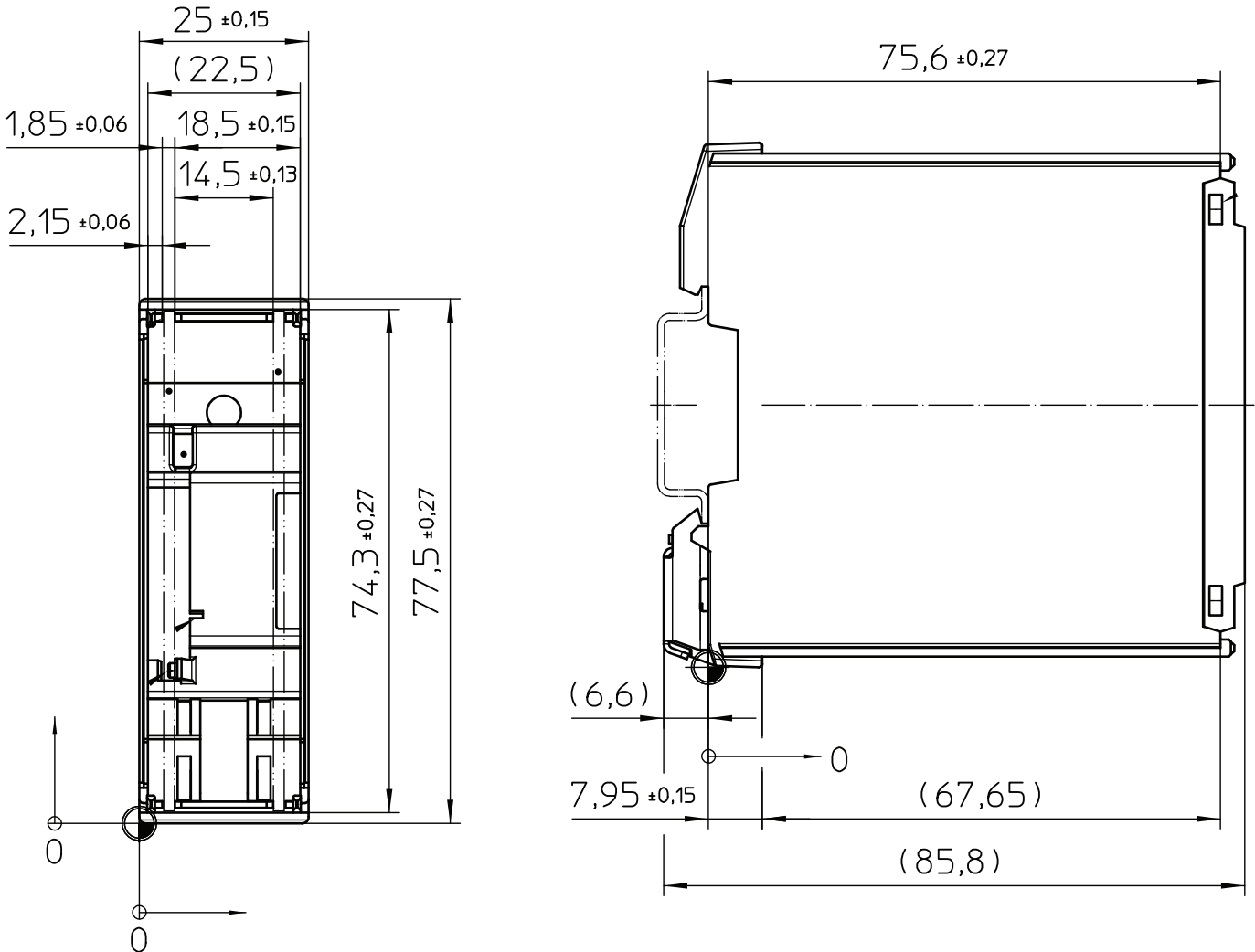

ORDERING CODE

